

# AAA TECHNOLOGY & SPECIALTIES CO., INC.

**FIG. 945**  
**ANCHOR BOLT – L – THREADED ONE END**

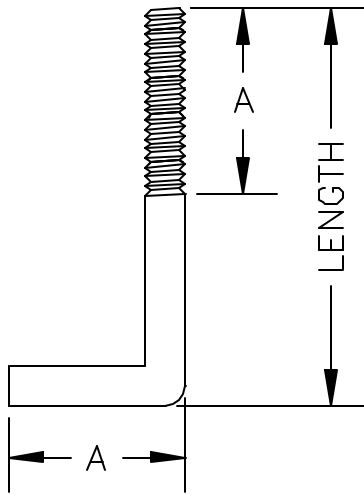

**APPLICATION:** Anchor Bolt – L – Threaded One End is designed to be embedded in concrete and used as an attachment point for equipment, pipe supports or structural steel.

**CONSTRUCTION:** An Anchor Bolt – L – Threaded One End is furnished in diameters from 3/8 inch through 1 1/2 inches. The standard thread lengths for each rod diameter are listed in the table.

**FINISHES AVAILABLE:** Black, Hot Dip Galvanized or Electro-Plated.

**ORDERING:** Specify figure number, rod diameter, length, name and finish, if other than black.

**EXAMPLE:** Fig. 945, 5/8" diameter, 28" long, Anchor Bolt – L – Threaded One End, HDG.

ROD DIA.	A (IN)	B (IN)
3/8	2	2 1/2
1/2	2	2 1/2
5/8	2 1/2	2 1/2
3/4	2 3/4	2 1/2
7/8	3	2 1/2
1	3 1/2	3
1 1/8	4	3 1/2
1 1/4	4 1/2	4
1 1/2	5 1/4	4